

Installation and Operation Instruction

The **FlowCon T-JUST** inserts are for use with four different FlowCon valve housings:

- ① FlowCon A DN15-25 (1/2"-1")
- ② FlowCon AB DN15-25 (1/2"-1")
- ③ FlowCon ABV DN15-25 (1/2"-1")
- ④ FlowCon FF-unit DN20 (3/4")

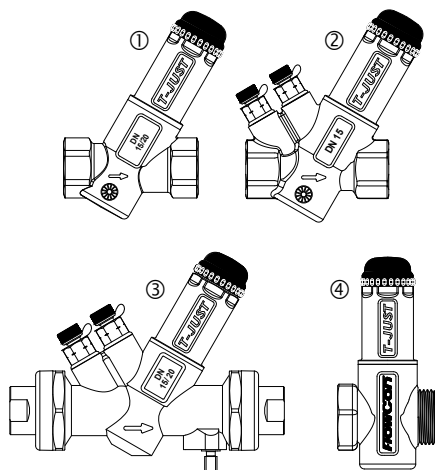

Figure 1

ATTENTION:

Please do not wind the FlowCon T-JUST below +36°C (+96.8°F) or above +65°C (+149°F) in order to keep the functionality of the FlowCon T-JUST intact.

Insert Setting and Installation

Prior to installing the FlowCon T-JUST it is recommended to grease the O-rings located around the T-JUST with silicone grease.

First setting may be done either before or after the T-JUST is installed in the valve housing. When fitting the T-JUST in the housing there is no need to use tools - the insert can be installed or removed with the fingers.

T-JUST's scale setting is located on top of the insert, going from +36°C to +65°C (+96.8°F to +149°F) with a factory pre-setting of +60°C (+140°F). To change the temperature setting, remove the black cover and set the scale to the desired temperature by adjusting the insert with a special adjustment key. After correct setting, be sure to turn the black cover back on finger tight to allow the thermostatic control to be working. Please note that when changing the temperature setting, the corresponding adjustment may take some time to get the system in complete balance.

By-pass Operation

By-passing the set temperature for system pasteurization purposes can be done either manually or electrically. In case of manual by-pass, simply remove the black top cover. If by-pass is required for a longer period, it may be sensible to place a red by-pass indicator ring (ACC0002) on the threads on top of the T-JUST and place the black cover above the red by-pass ring to make manual by-pass operation deliberately visible. In case of electrical by-pass, install a thermal ON/OFF actuator (EV.0.3.R/0.4.R) on T-JUST instead of the black cover. The actuator may be controlled either by a local timer or connected directly to the BMS-system. Please see specific installation instruction for EV-actuators (R=red adaptor ring).

FlowCon T-JUST 15-25 mm (1/2"-1")

1Q95000 - 09/2020

General Assembly Drawing FlowCon T-JUST

- A: Valve housing
- B: T-JUST insert
- C: Adjustment key
- D1: P/t plug (2 pcs.)
- D2: Plug (2 pcs.)
- E: Union end connections
- F: FlowCon actuator incl. adaptor ring
- G: Cover
- H: Manual by-pass ring.

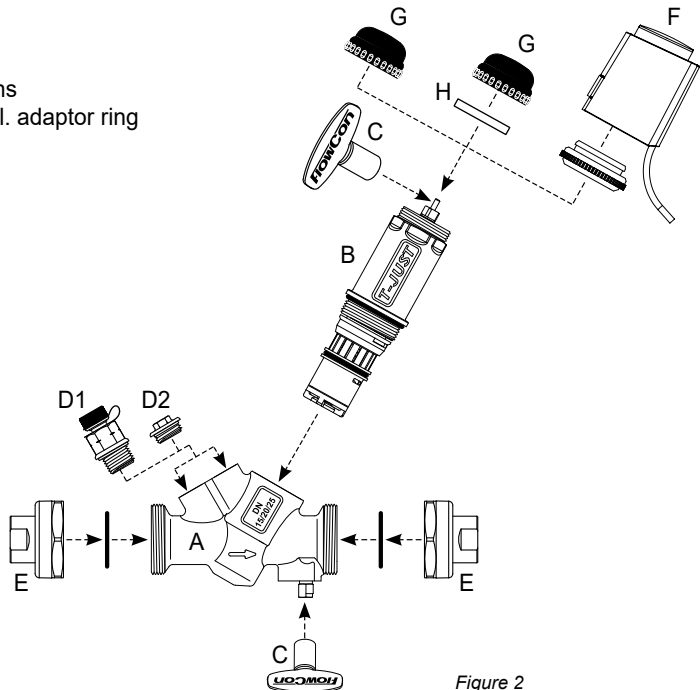

Figure 2